

# POLYMAT ROOF

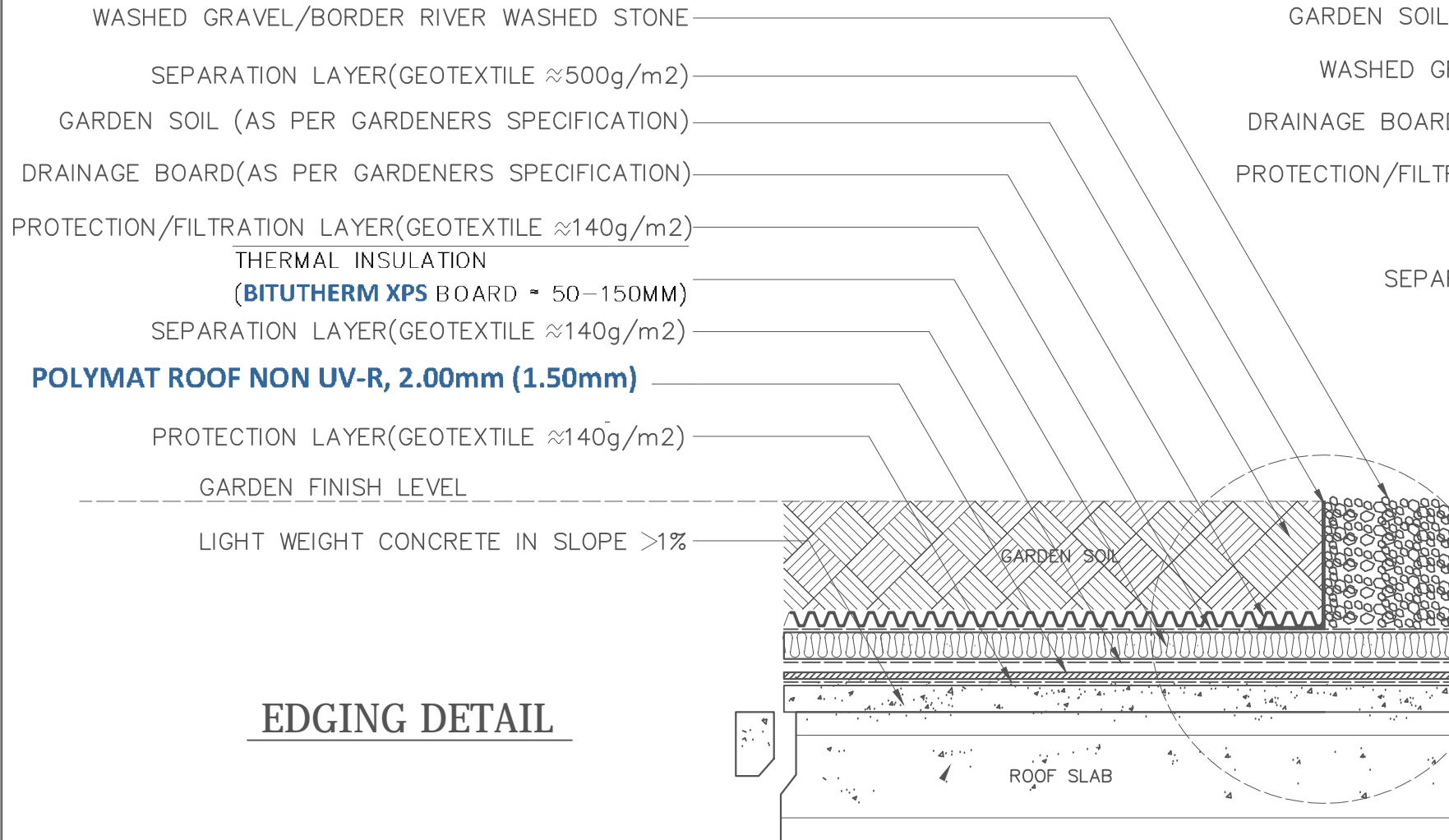

**EDGING DETAIL**

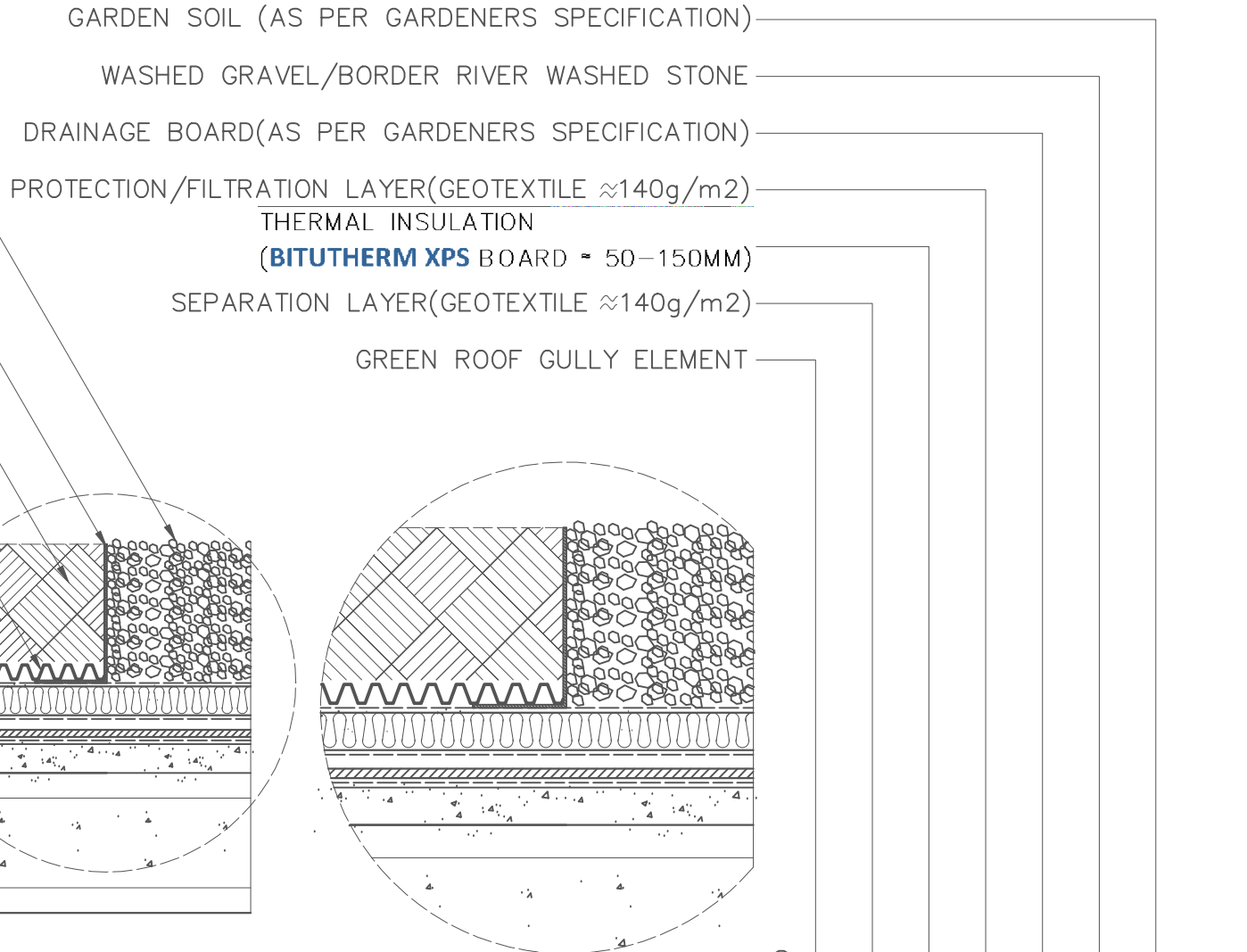

**DRAINAGE DETAIL**

**NOTES:**

1. DRAINAGE ARE AS PER LANDSCAPER/GARDENER'S SPECIFICATIONS.
2. GARDEN SOIL REQUIRED DEPTH ACCORDING TO LANDSCAPER/GARDENERS GREENERY TYPES OR SELECTIONS. DEPTH VARIES ACCORDINGLY.
3. GARDEN ROOF SPECIFIED PVC WATERPROOFING MEMBRANE BY BITUMAT IS ABSOLUTELY ROOT PROOF.
4. GARDEN ROOF WATERPROOFING SYSTEM DESIGN FOR GRASS AND SHRUBS ONLY. USE OF HEAVY GREENERIES/PLANTS IS SUBJECT TO CHANGES.
5. GARDEN ROOF WATERPROOFING SYSTEM DESIGN WILL BE RE-DESIGNED AND CHECKED ONCE THE FULL DETAILS OF THE GARDEN ROOF DRAWINGS AND SPECIFICATIONS ARE FURNISHED BY THE CONSULTANT & LANDSCAPER.

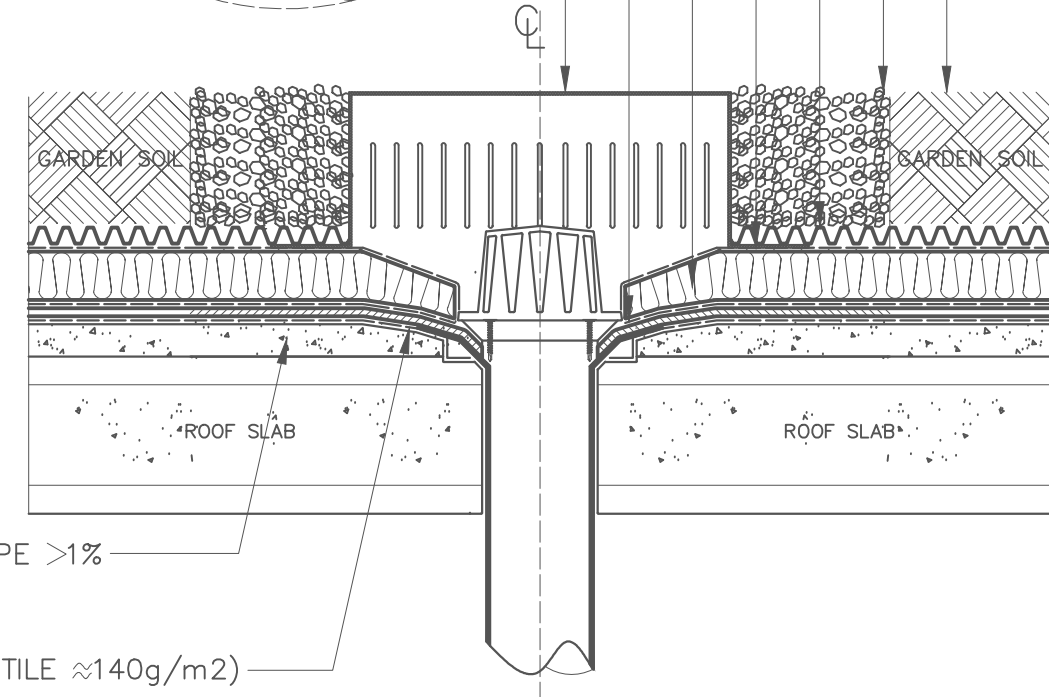

**BITUMAT COMPANY LIMITED**  
 P.O. Box 7487, Dammam 31462, Kingdom of Saudi Arabia  
 Tel. No. (+966-13) 8121210 / 8121213  
 Fax No. (+966-13) 8121190  
 Google Earth Address: 2608 34327-6935  
 Website: www.bitumat.com

THIS DRAWING IS FOR ILLUSTRATIVE PURPOSES ONLY OF PROFILES SHOWN IN OUR OFFICIAL CATALOGUE. ALL PROFILES MUST BE VERIFIED AND APPROVED BY THE AUTHORIZED REPRESENTATIVE OF BITUMAT BEFORE ANY ACTION IS TAKEN.	DRAWING TITLE		REVISION		DRAWN BY :	DWG. No.
	POLYMAT PVC - SINGLE PLY (Inverted Roof) ROOF GARDEN (GREEN ROOF)		0.0 DATE :		CHECKED BY :	MS.01.02-14
SHEET CONTENTS : ROOF GARDEN SYSTEM DETAIL		REMARKS		REF. NO.		
		EXEMPLARY PROJECT				